

## 50-K-58 - SPEEDLINE System Data Sheet - Version V1 (24-10-23)

SPEEDLINE 50mm 'C' Stud Partition @600mm Ctrs,  
with 2x Knauf 15mm Wallboard each side

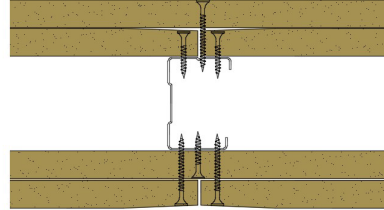

### System Performance Breakdown

Fire Resistance:

BS476 Part 22:1987:

Test Ref & Date or Applied Ref & Report:

Max Height:

Thickness:

Duty Grade: BS 5234: Part 2:1992:

Sound Insulation:

**60/60 Minutes** (Integrity/Insulation).

**BRE 208596 - BRE Report P102396-1011B**

**Refer to Speedline Specification Clause**

**112 mm.** (At Base Track, Excluding Finishes)

**Severe - Annexes A-F**

**42  $R_w$ dB**, Date Tested or Assessed Against - 50-K-57

Test Code:	H17386CA
Test Date:	16/06/2011

Freq. Hz	R dB
50	21.7
63	17.0
80	14.2
100	13.0
125	15.4
160	29.1
200	30.7
250	32.2
315	34.7
400	40.4
500	46.8
630	48.4
800	51.6
1 000	53.5
1 250	56.3
1 600	59.2
2 000	59.3
2 500	50.1
3 150	46.1
4 000	51.5
5 000	53.5
6 300	
8 000	
10 000	

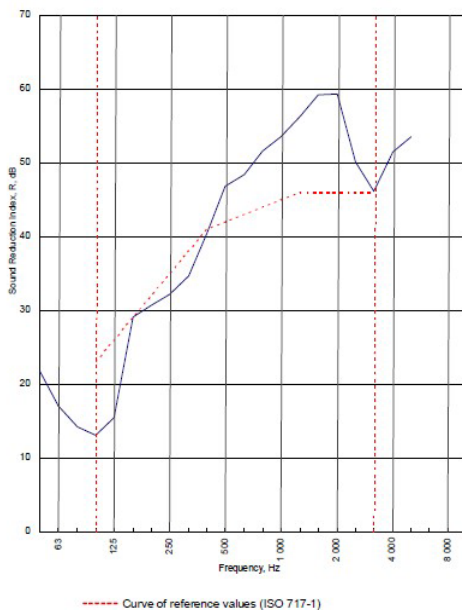

Rating according to BS EN ISO 717-1:1997	<b><math>R_w</math> (C;Ctr) = 42 (-4;-11) dB</b>		
Evaluation based on laboratory measurement results obtained by an engineering method	Max dev. 10.6 dB at 125 Hz		
	$C_{50-150} = -5$ dB	$C_{50-500} = -4$ dB	$C_{100-500} = -3$ dB
	$C_{8-50-315} = -13$ dB	$C_{8-50-1000} = -13$ dB	$C_{8-100-5000} = -11$ dB

TESTED AT ONE OF THE UKAS ACCREDITED LABORATORIES BELOW

B.T.C  
(H-Ref on Graph)

B.R.E

AIRO

S.R.L

Customer: Metsec plc Hepsec Division

BTC 17407A: Page 8 of 10



SPEEDLINE Drywall Systems, Adsetts House, 16 Europa View, Sheffield Business Park, Sheffield, S9 1XH.

Tel: 0114 231 8030.

Email: [enquiries@speedlinedrywall.co.uk](mailto:enquiries@speedlinedrywall.co.uk)

(As per the requirements set out in ISO/IEC 17025:2017 regarding test data the results stated have been carried out by voestalpine Metsec plc as part of the contract to supply Speedline Metal Sections to SIG Plc)